

Barrel sauna room

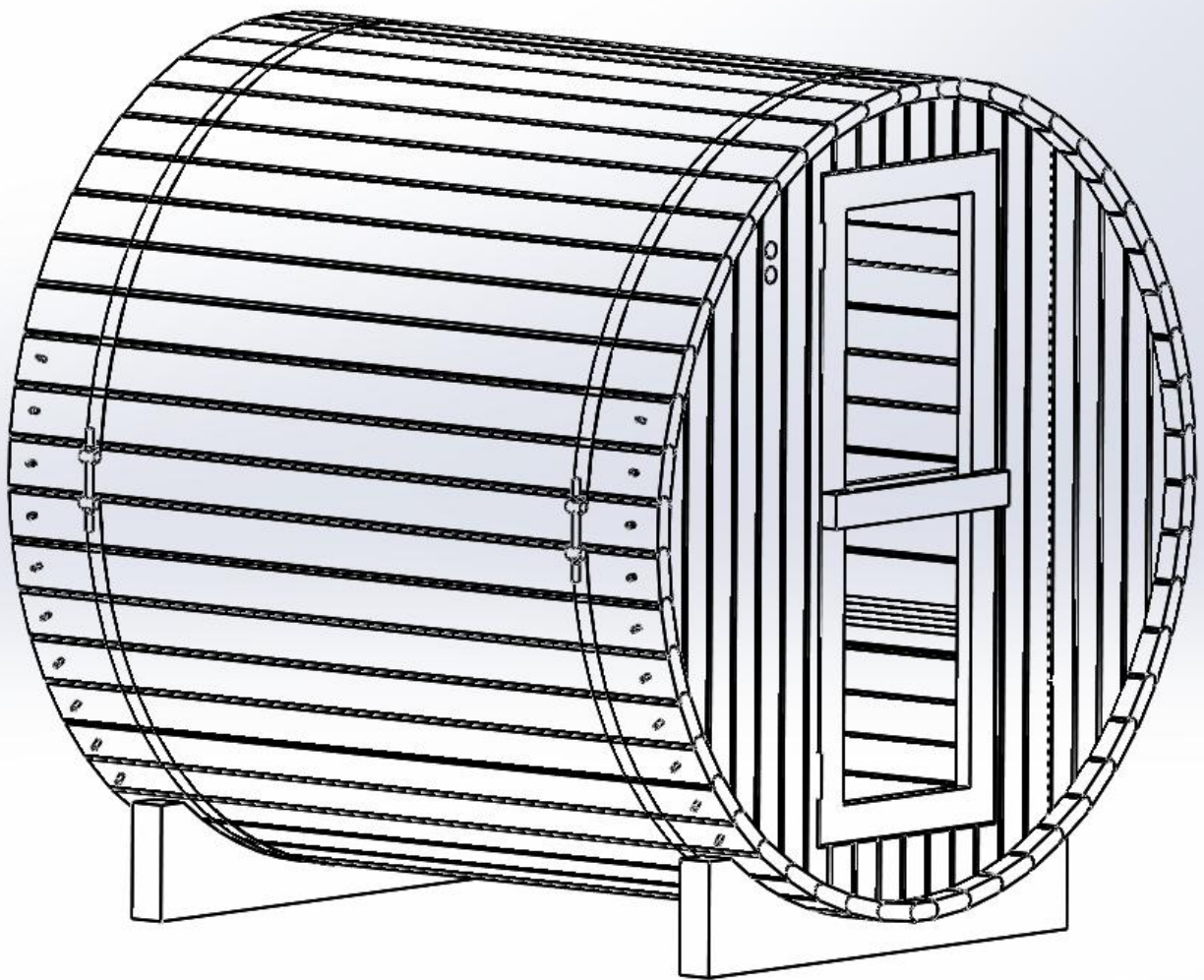

1. Front wall

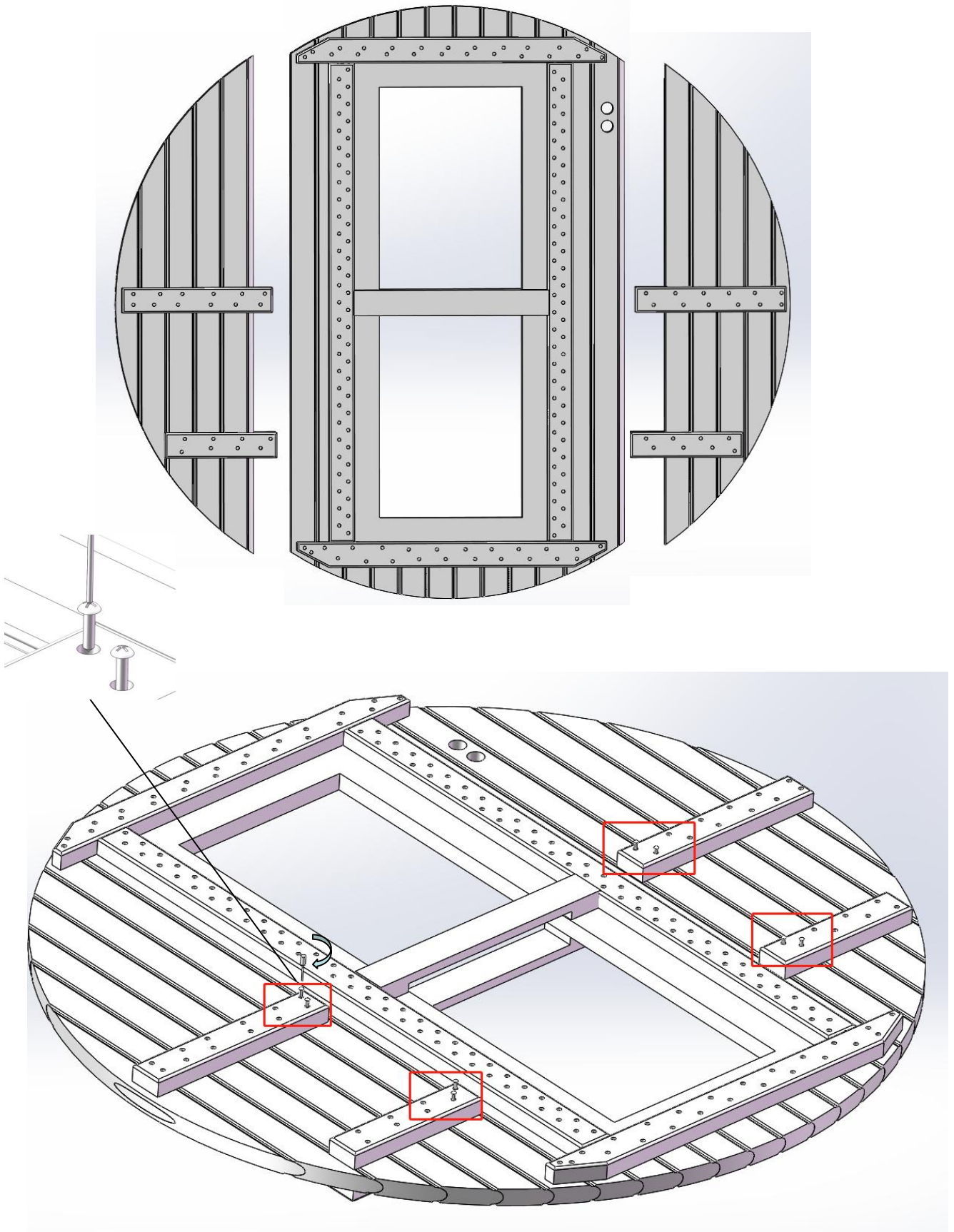

2. Back wall

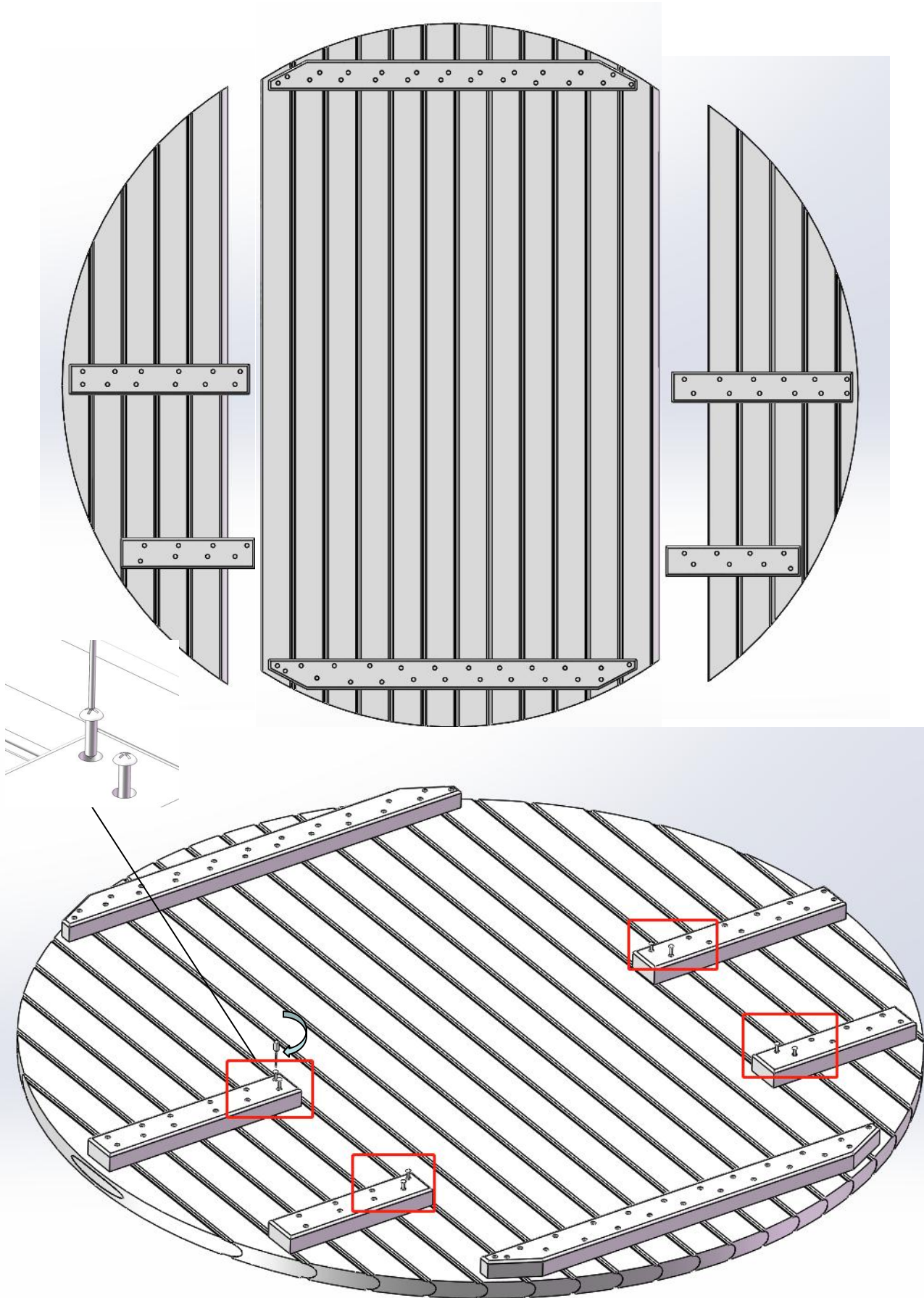

3. Base horizontal

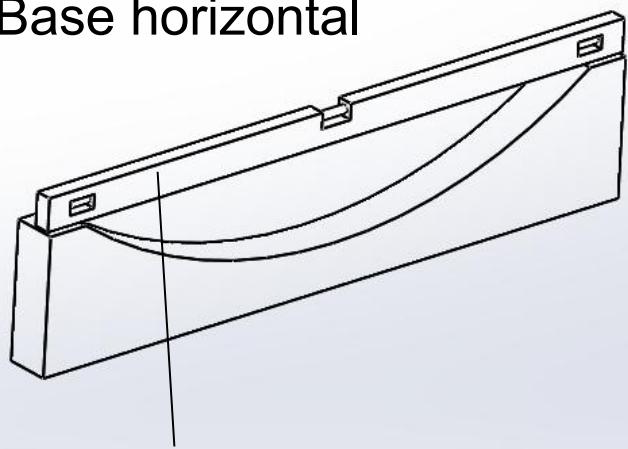

To test to maintain the same horizontal level

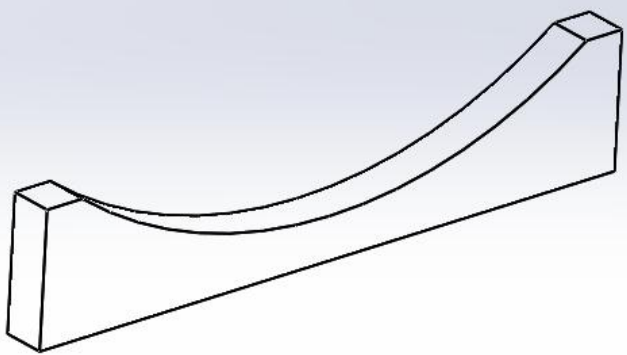

4. Base and the first stave

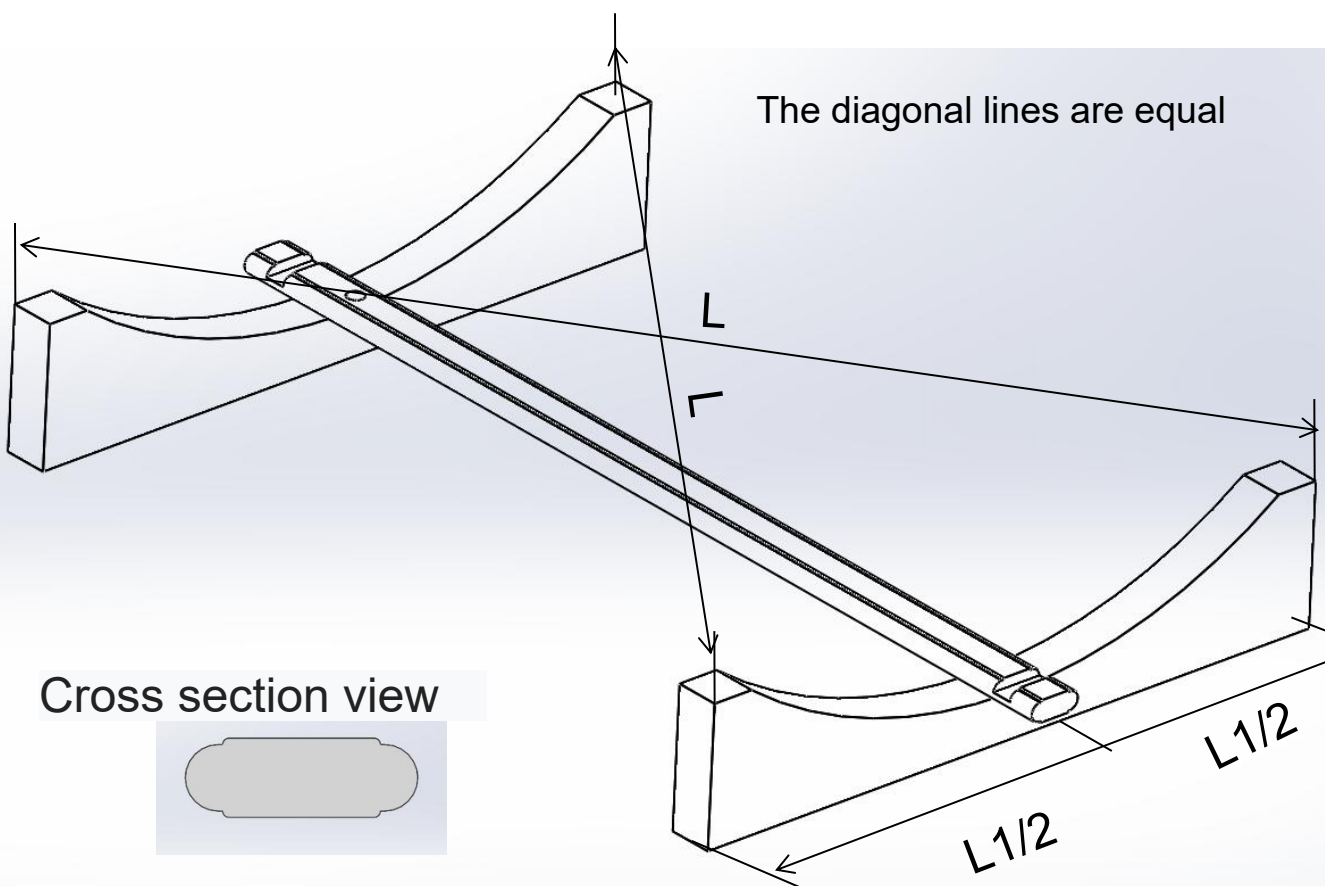

Cross section view



5. Lock the stave

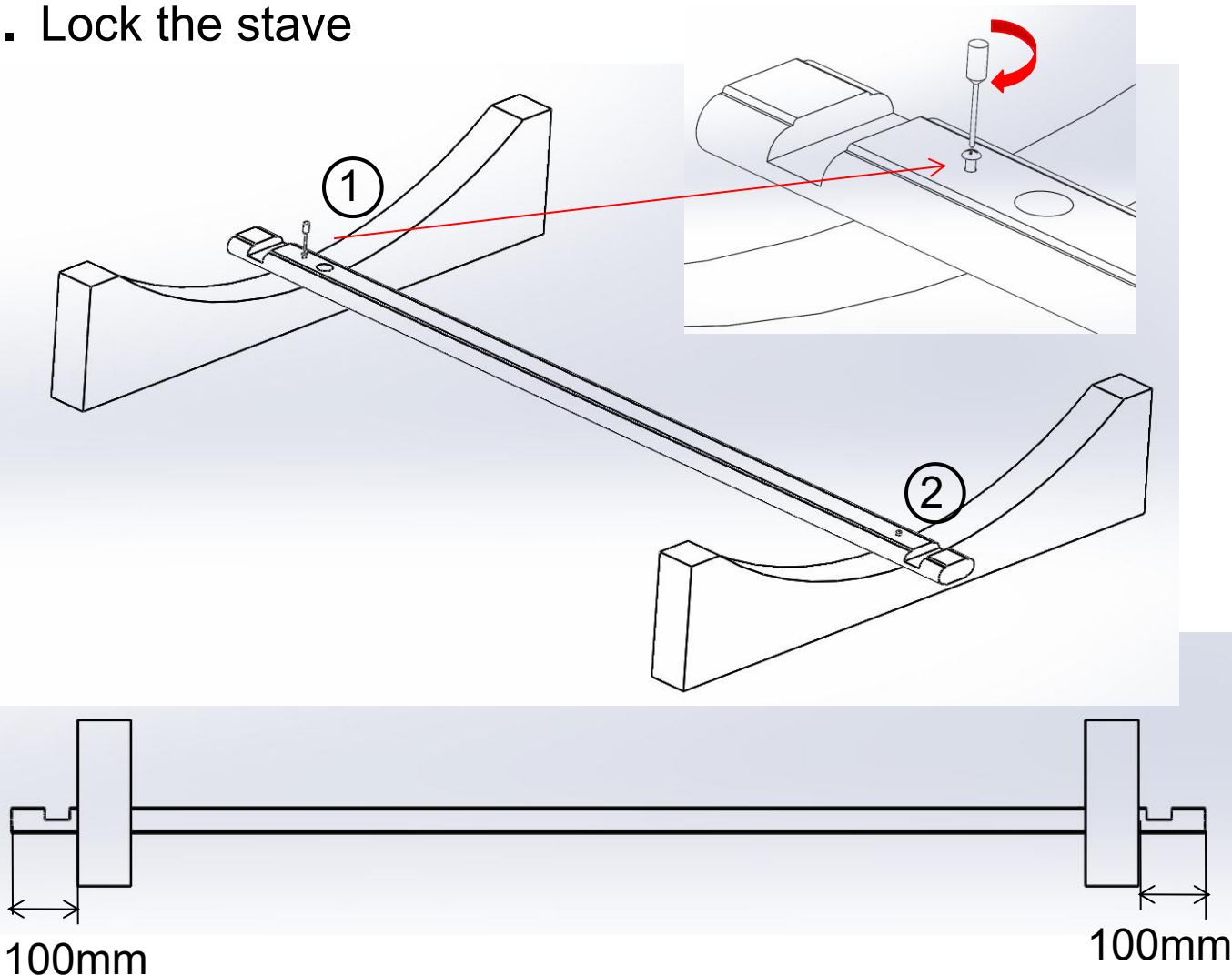

6. Add the left and right stave

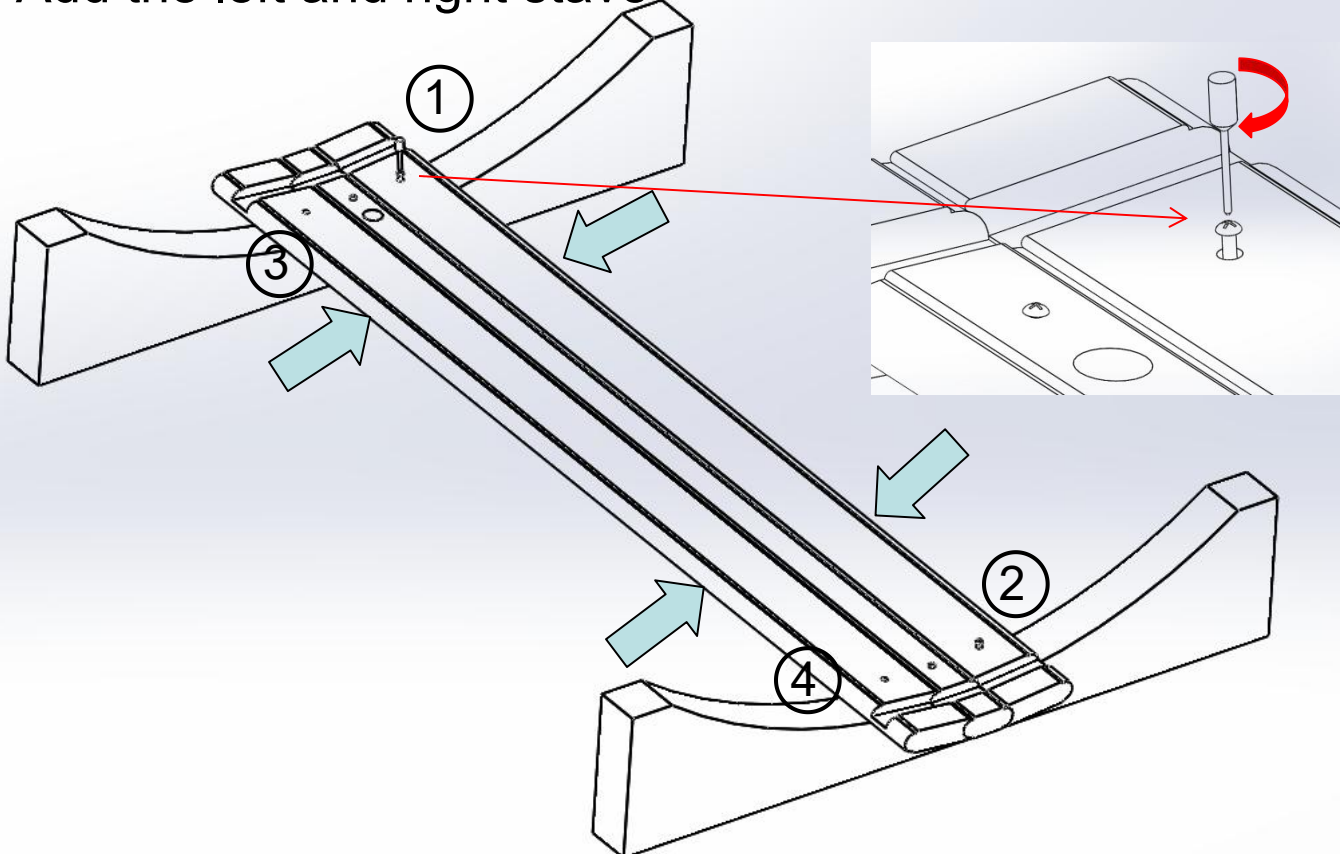

7. Place the wall

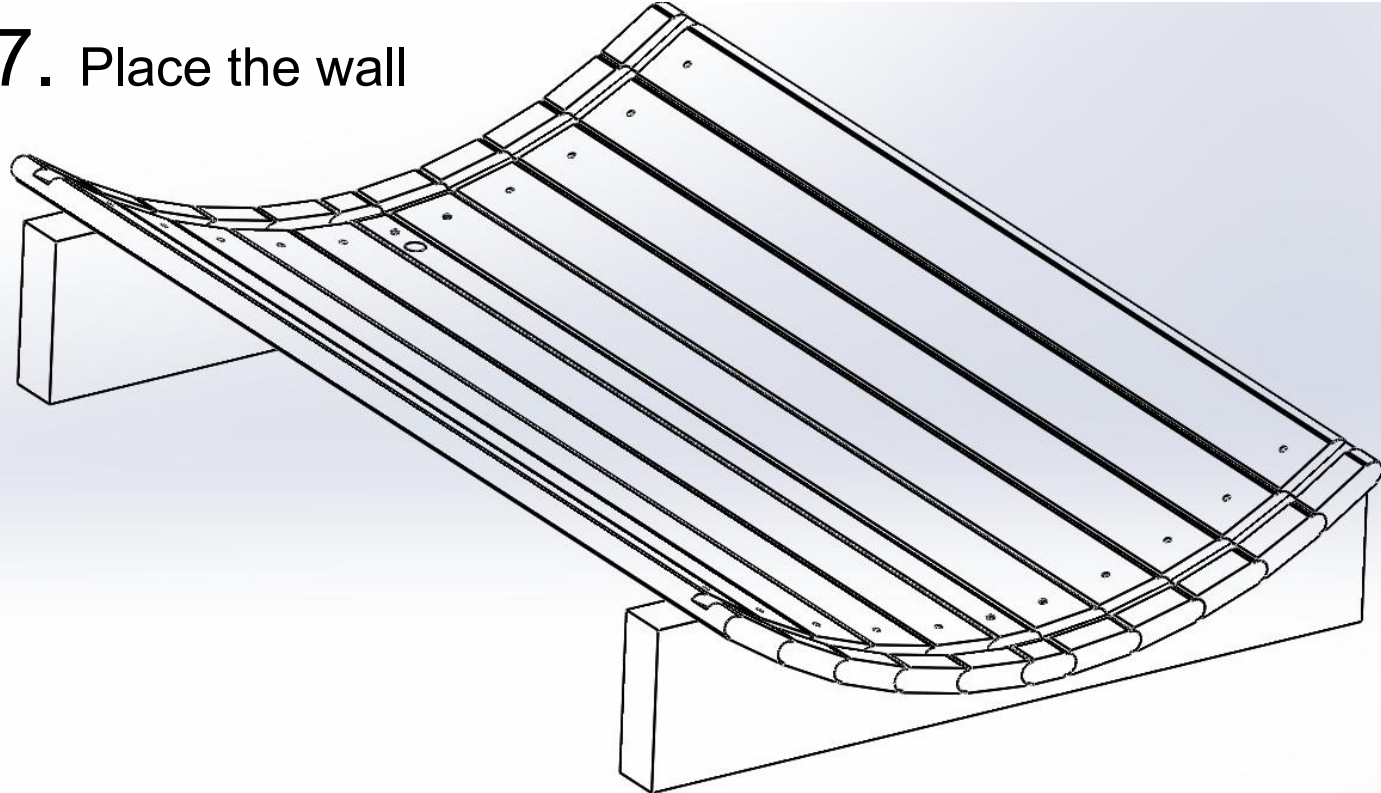

8. Back wall

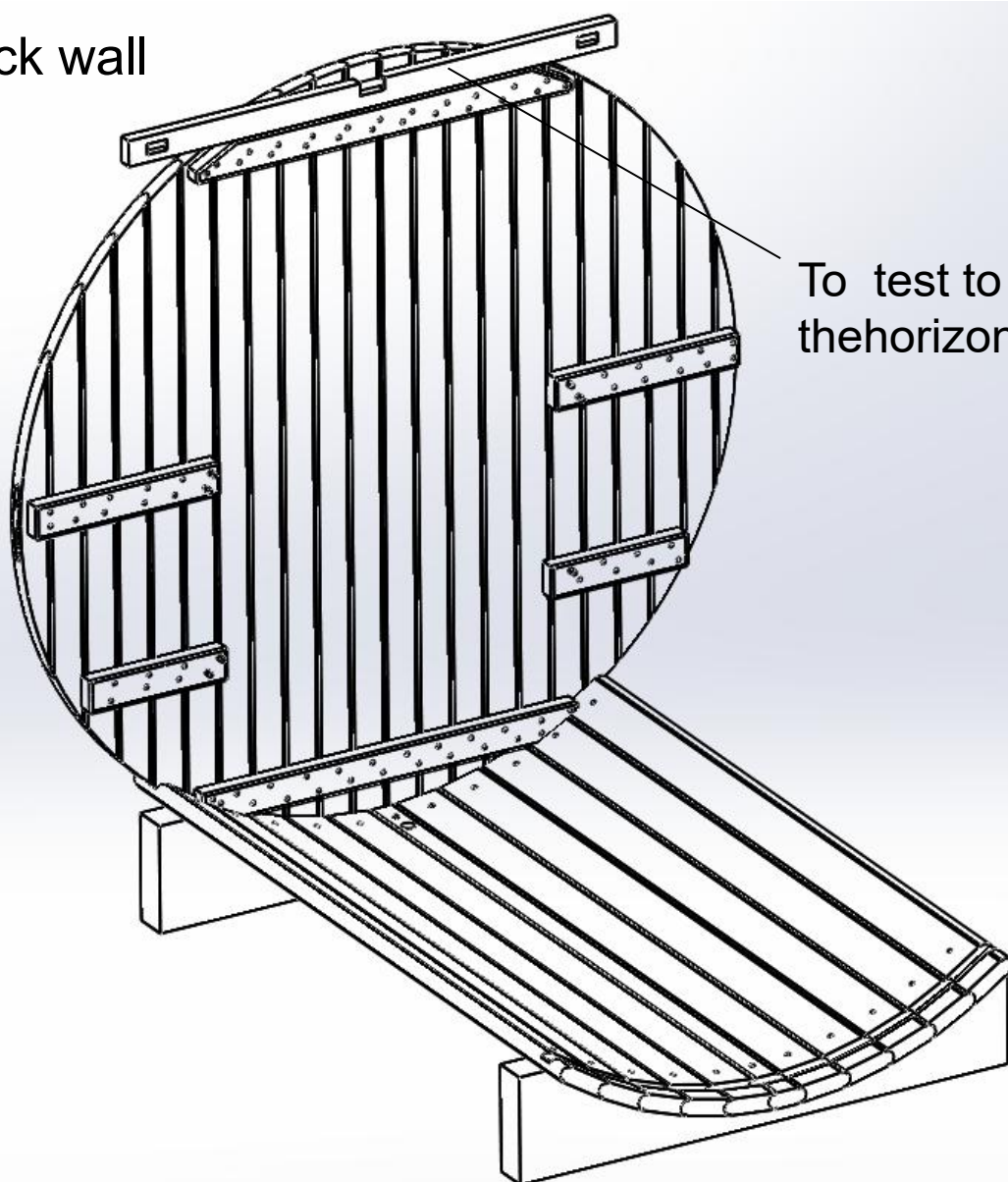

To test to maintain
the horizontal

9. Front wall

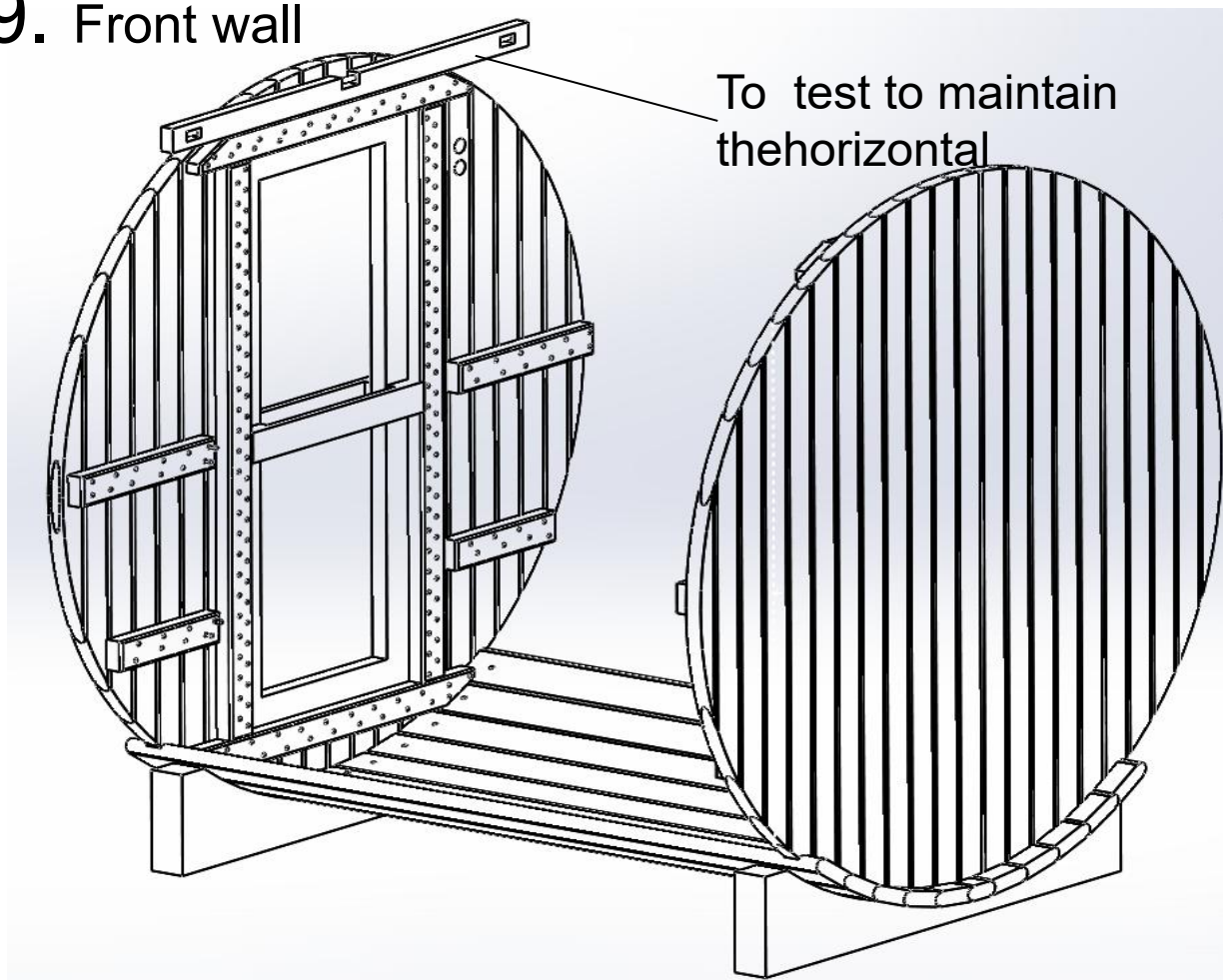

10. Place the wall

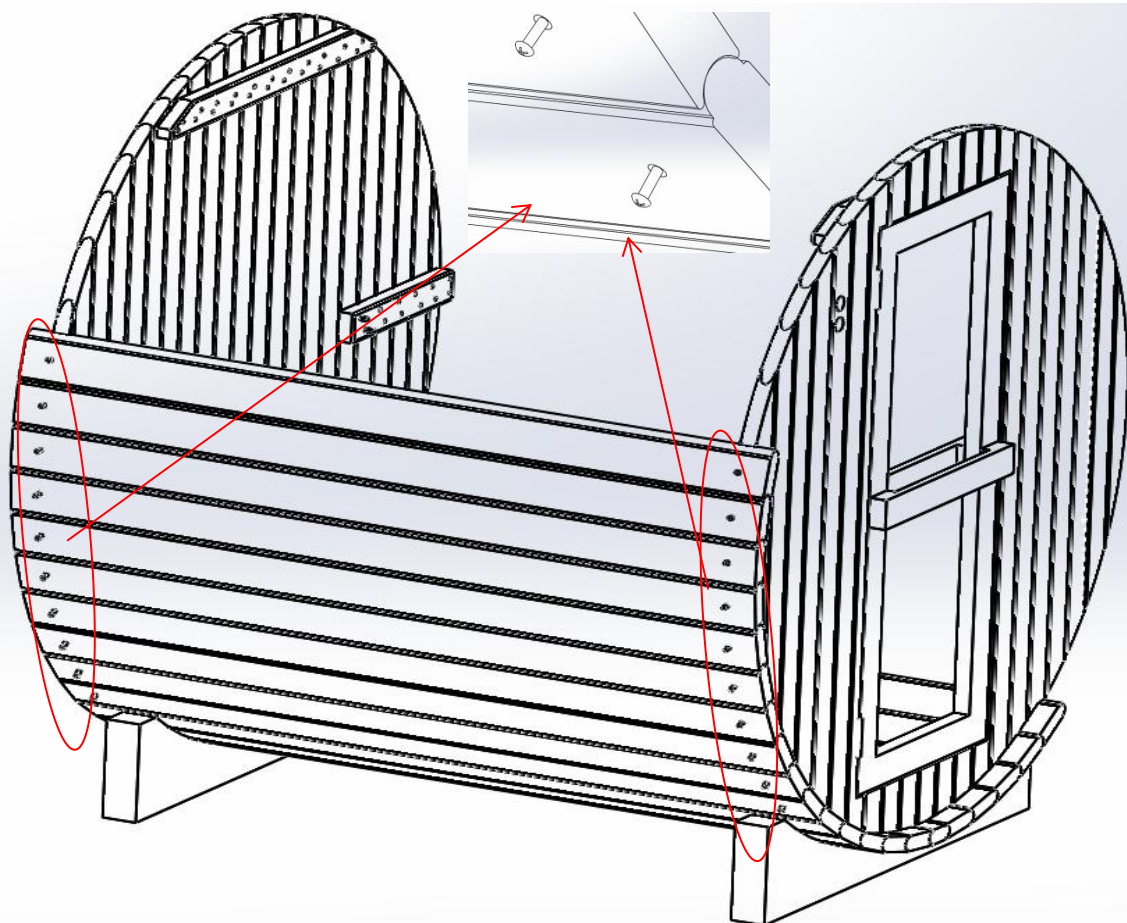

11. Place the wall

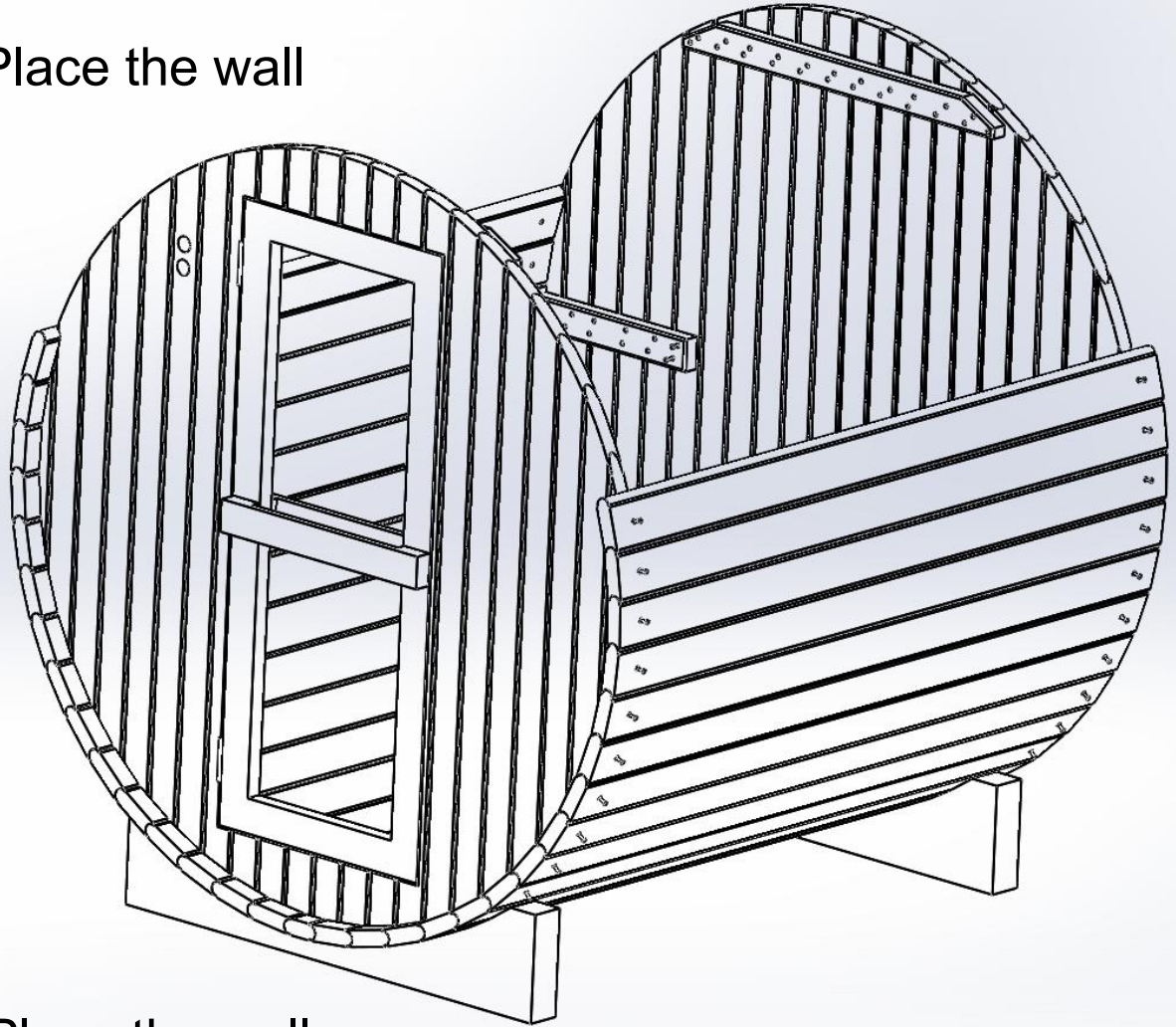

12. Place the wall

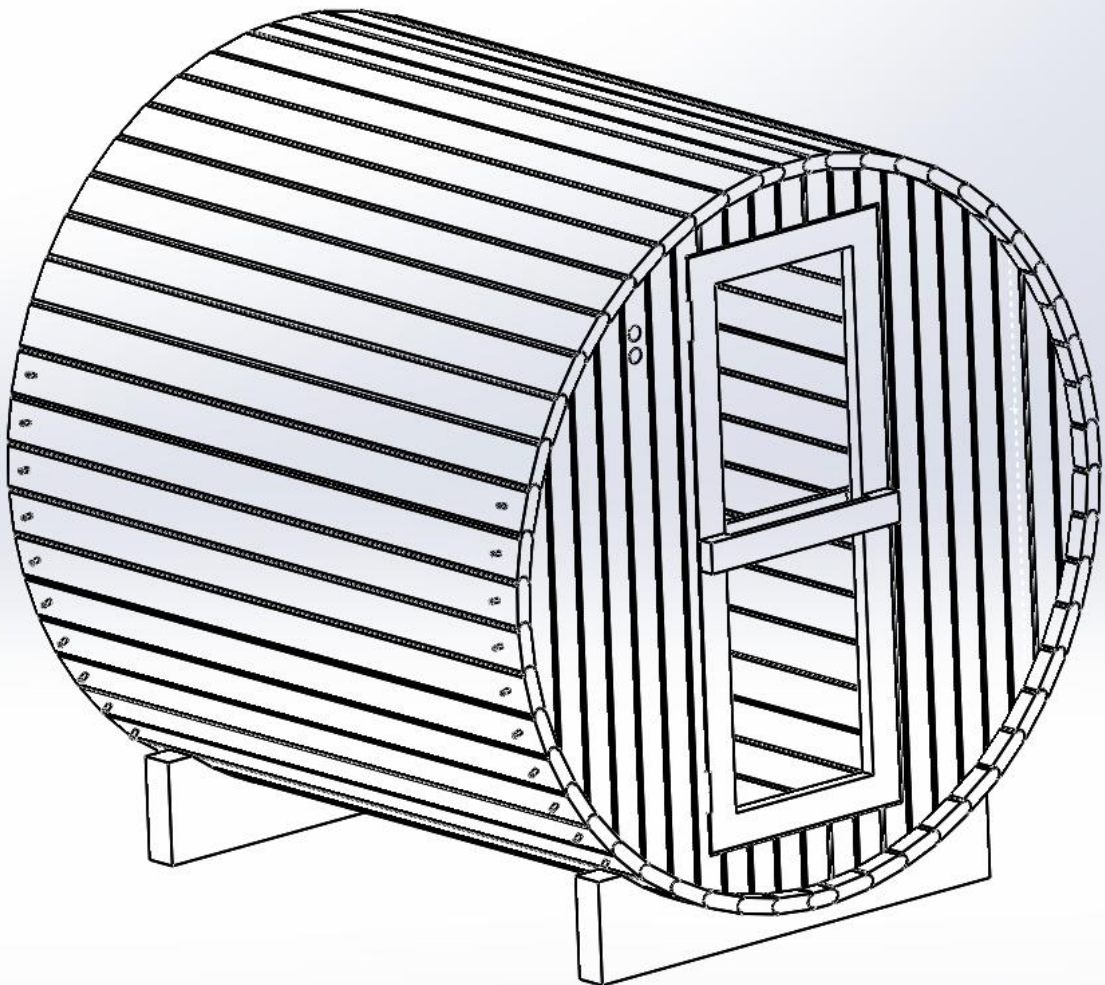

13. Wall panels

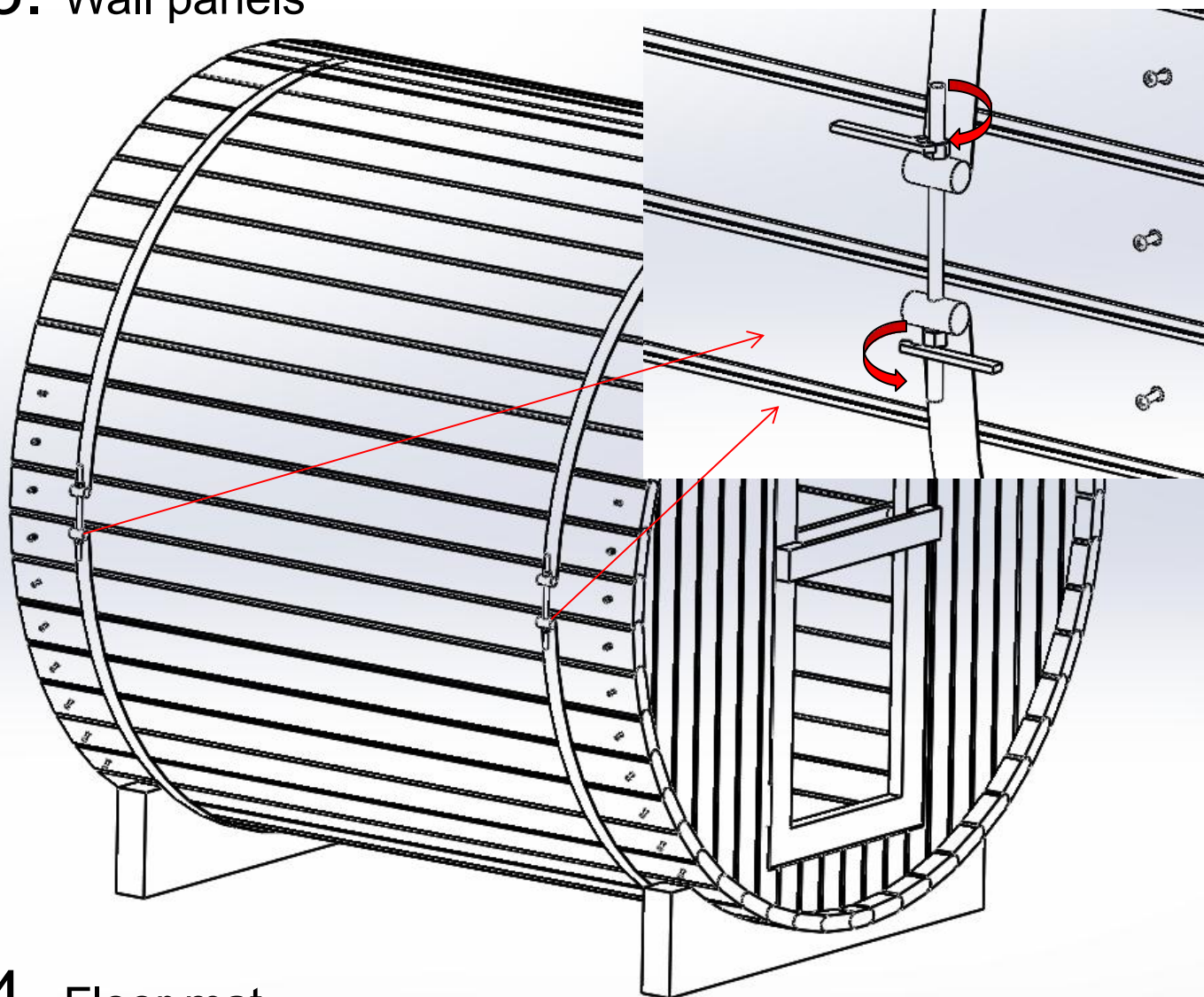

14. Floor mat

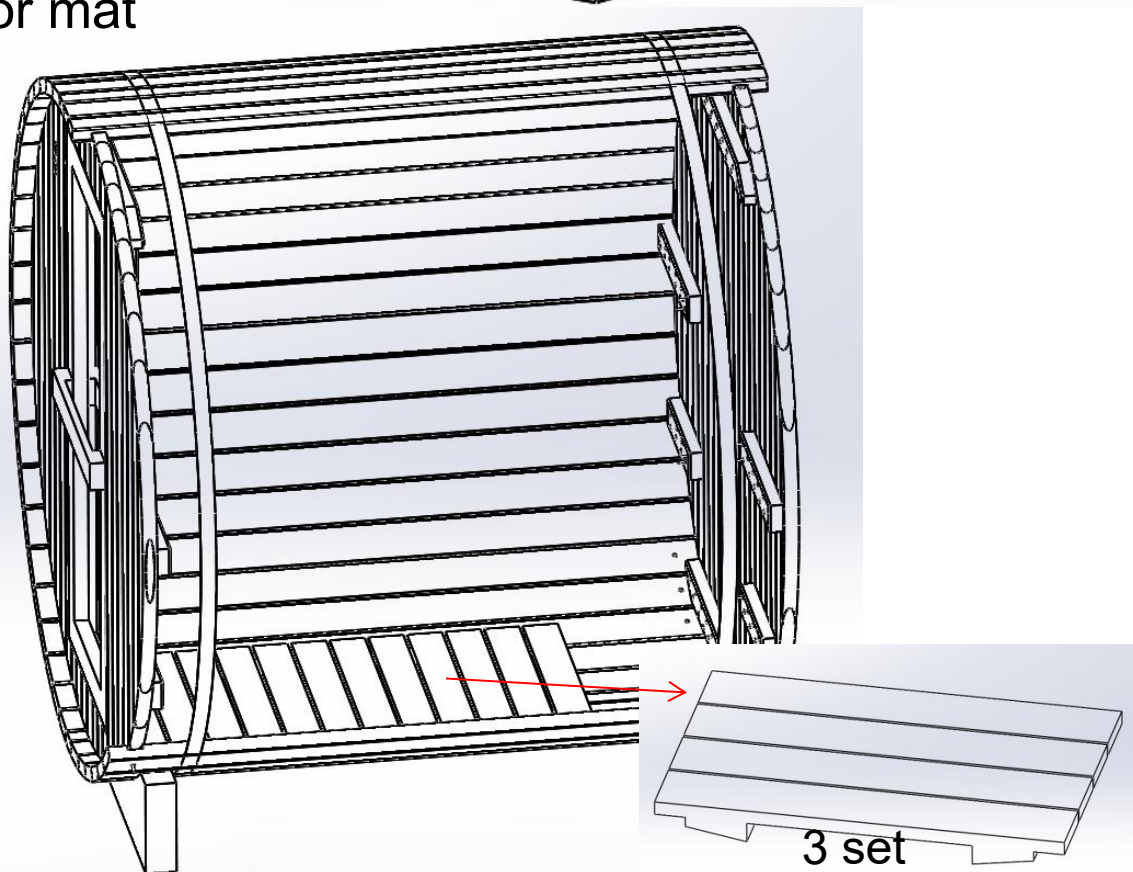

15. Lock floor mat

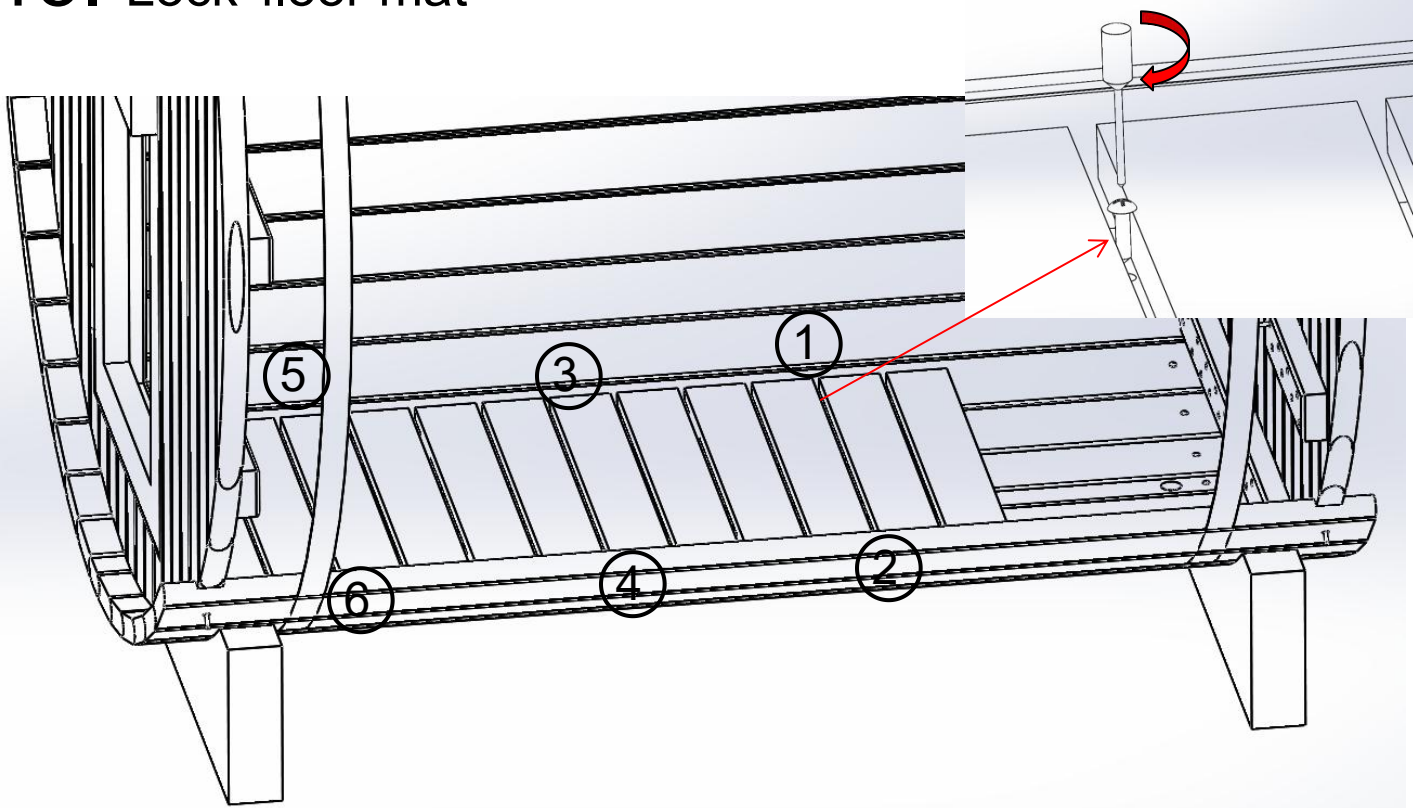

16. Place bench

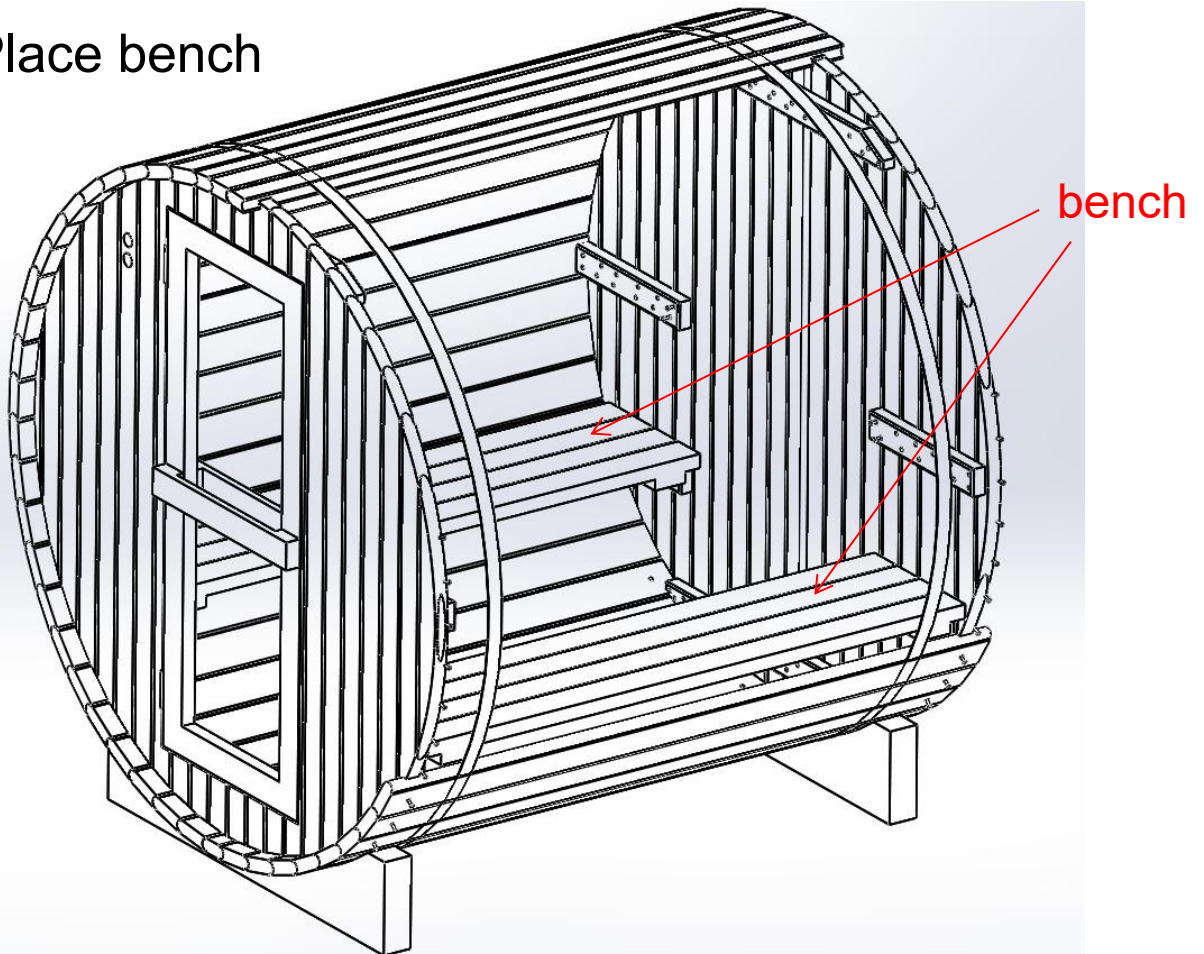

17、 Add bench support plate and lock

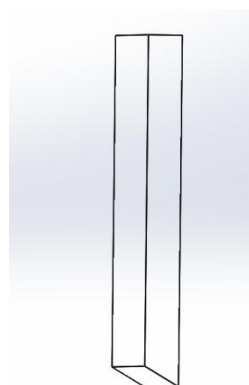
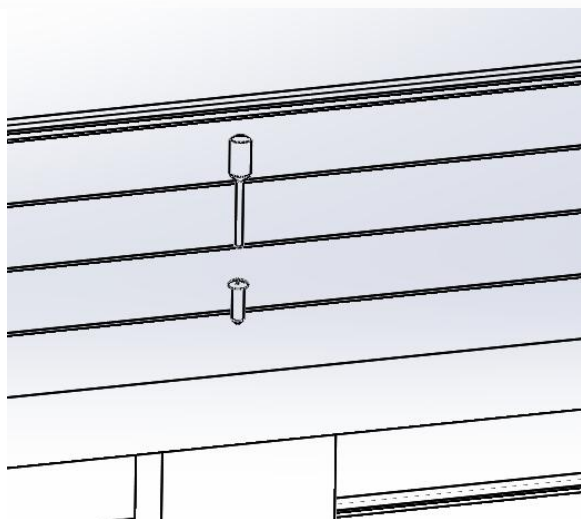
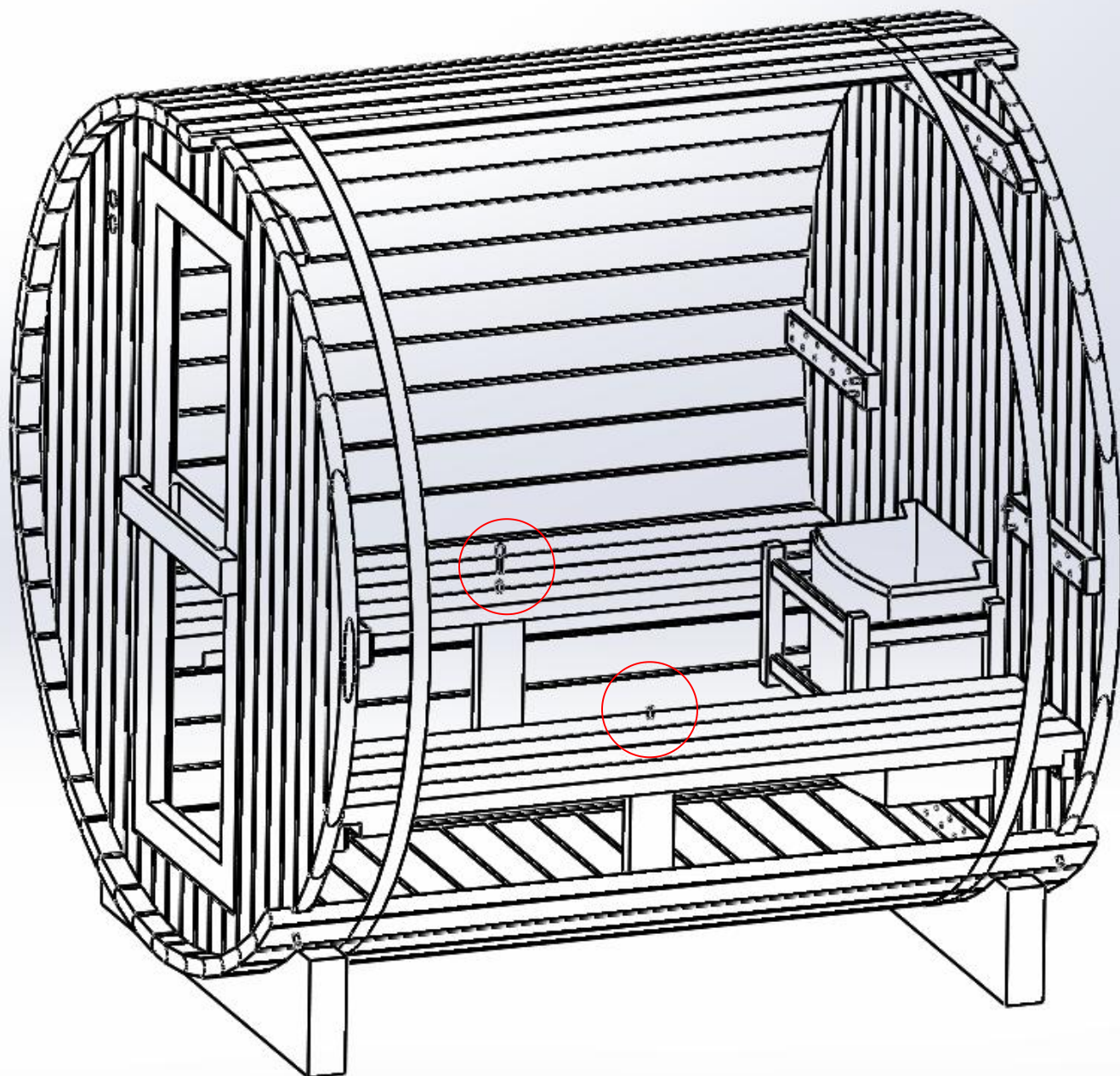

2 set

18. Rock guard

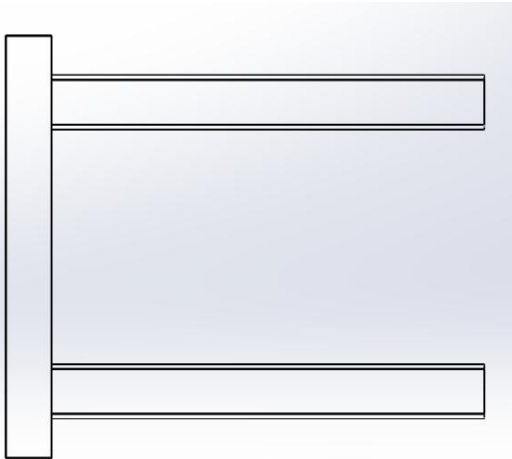
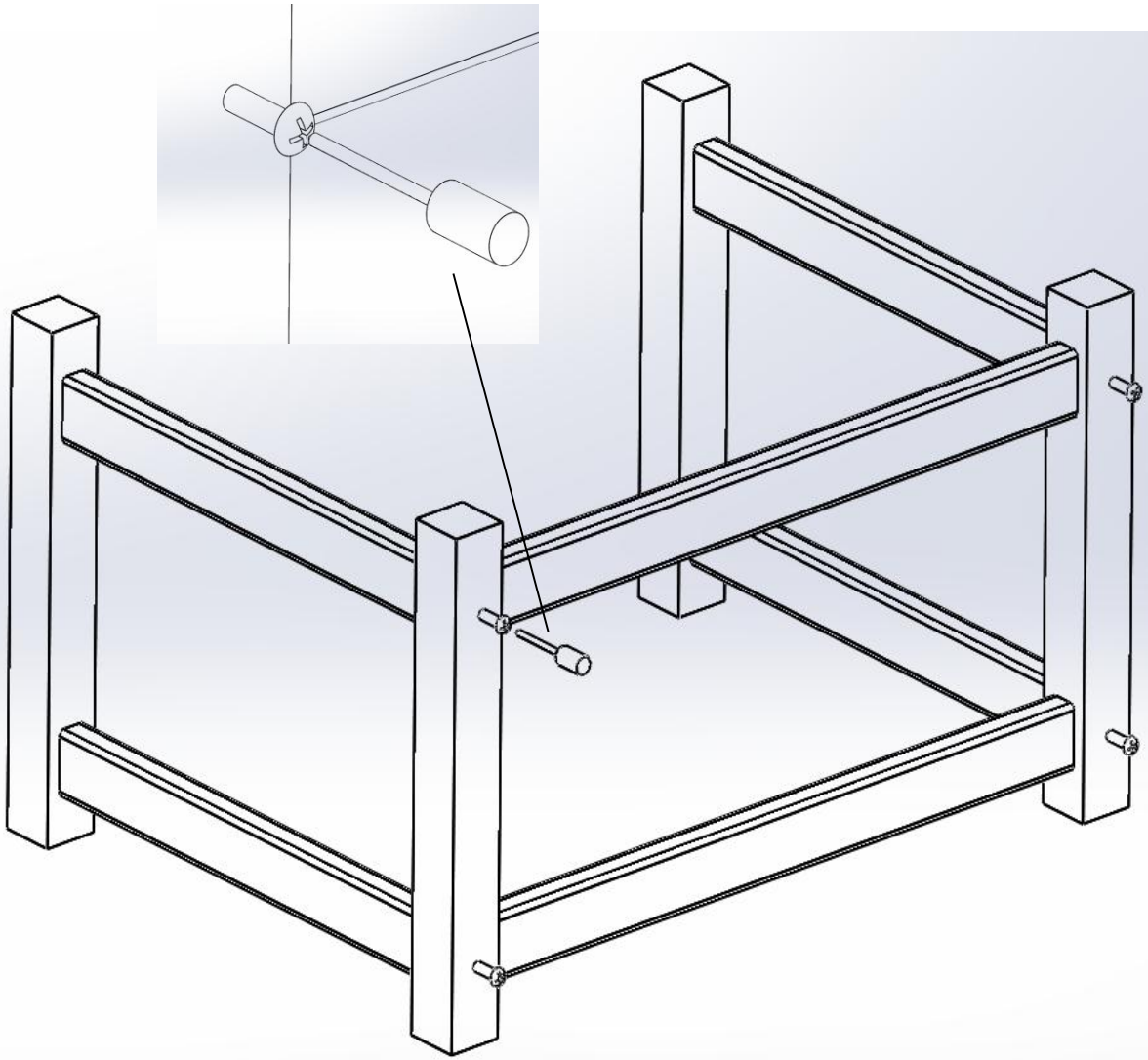

2 set

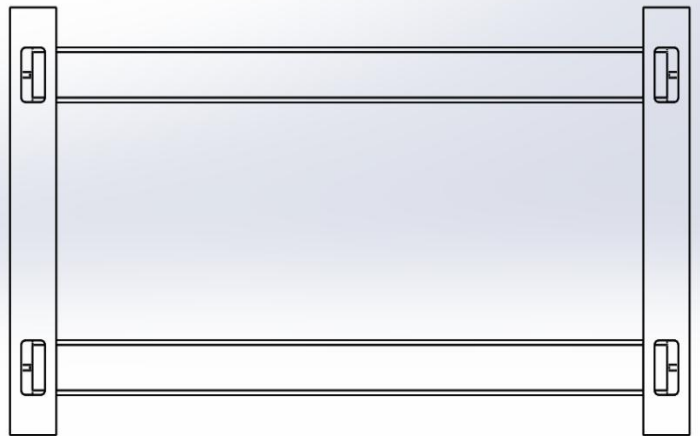

1 set

19. Rock guard

